

# DOUGLAS

**11" STROKE SHAPER  
10½" CUT**

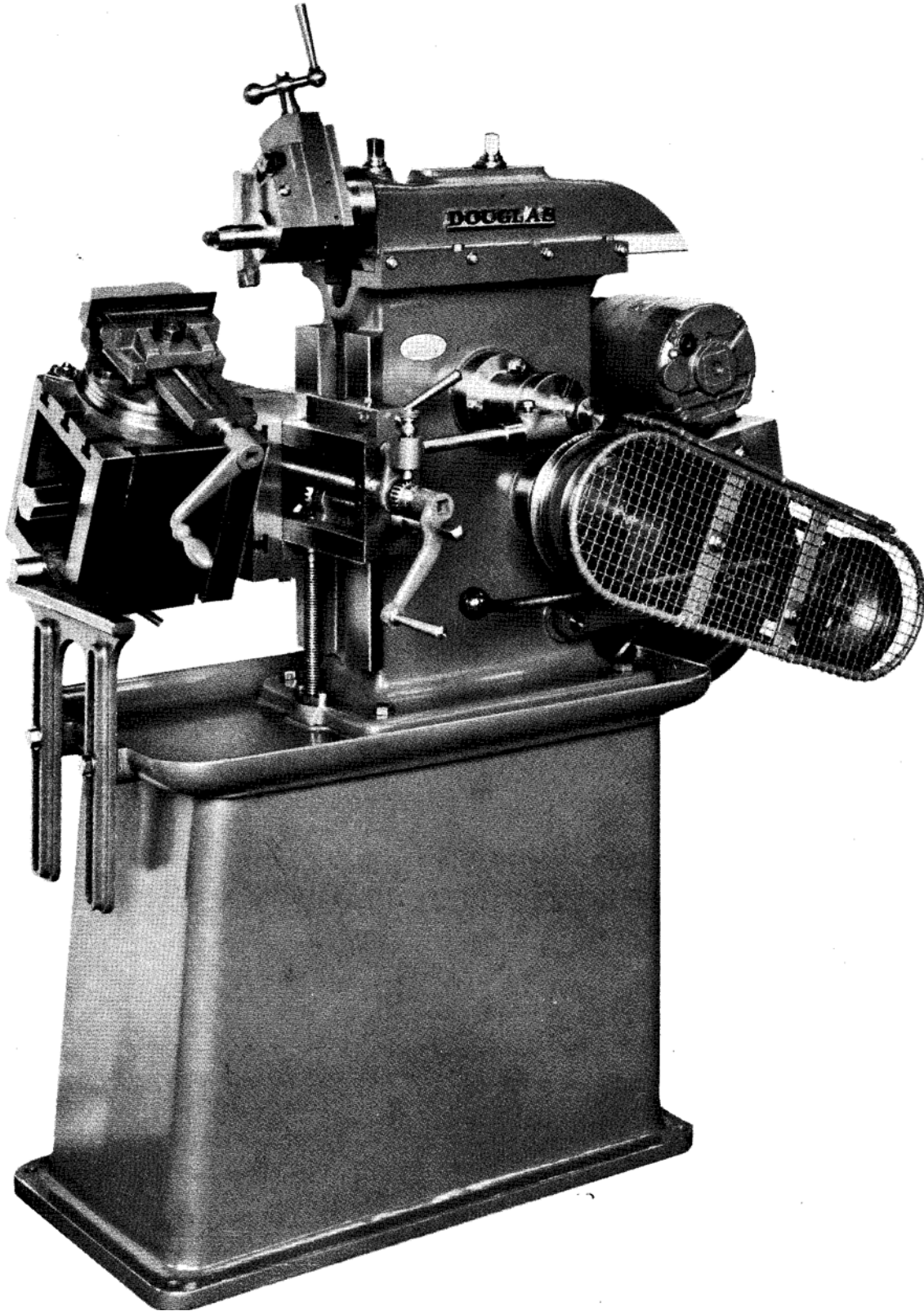

*Built for High-speed precision work...*

PLATE TH

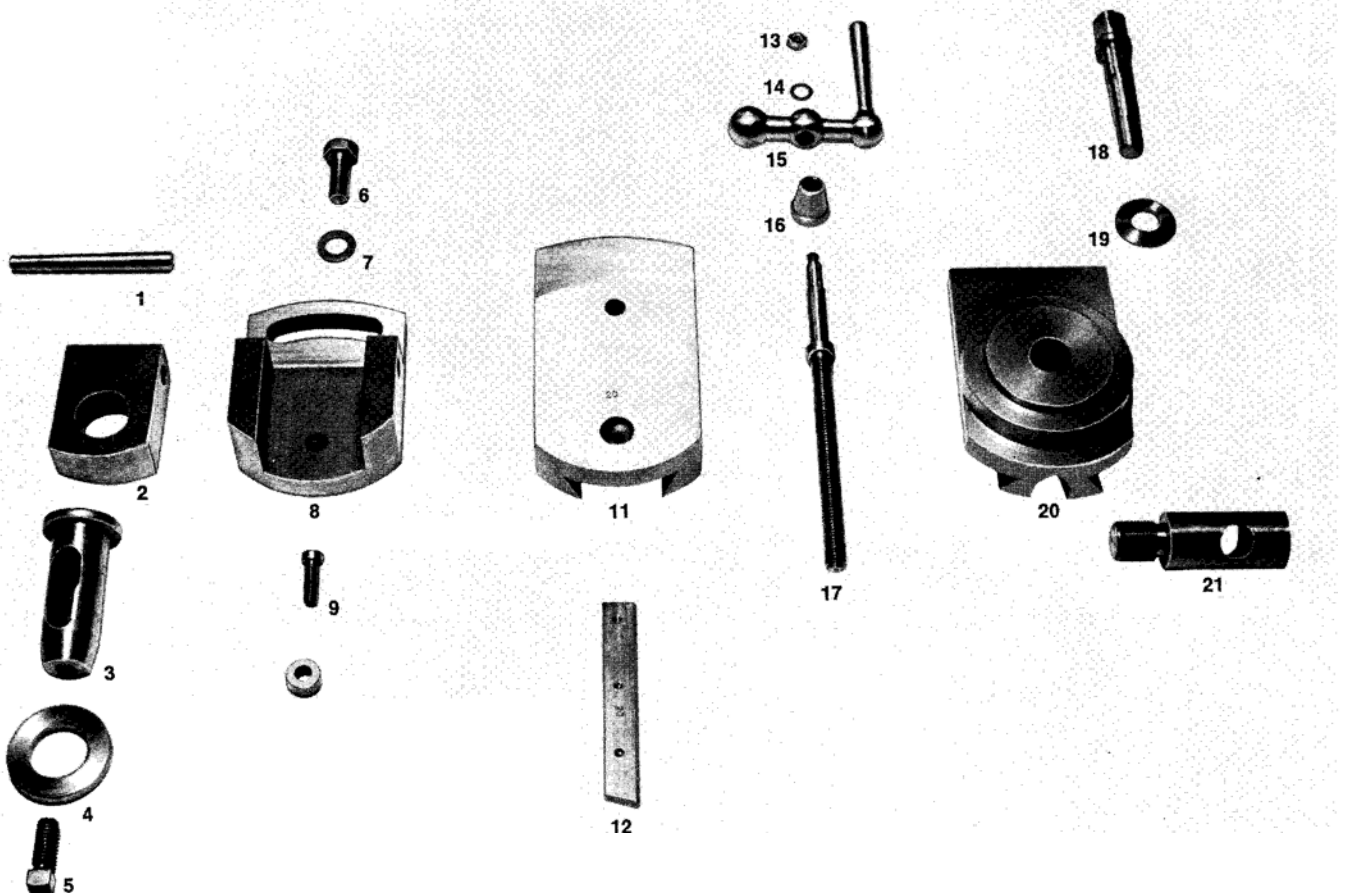

- |                    |                    |                         |
|--------------------|--------------------|-------------------------|
| 1 Taper Pin        | 8 Clapper Box      | 15 Ball Handle          |
| 2 Clapper Block    | 9 Swivel Screw     | 16 Calibrated Collar    |
| 3 Tool Post        | 10 " Collar        | 17 Tool Head Lead Screw |
| 4 " " Washer       | 11 Tool Head Slide | 18 Eccentric Lock Pin   |
| 5 " " Set Screw    | 12 " " Gib Strip   | 19 Bevel Washer         |
| 6 1½ x ½ Set Screw | 13 5/16 Nut        | 20 Tool Head Base       |
| 7 ½" Washer        | 14 " Washer        | 21 " " Stud             |

When ordering spare parts please quote Plate and Part number thus: "2 ONLY TH10"

*For quick service, order all spares from your selling agent, they carry a full range of parts for your convenience.*

PLATE BP

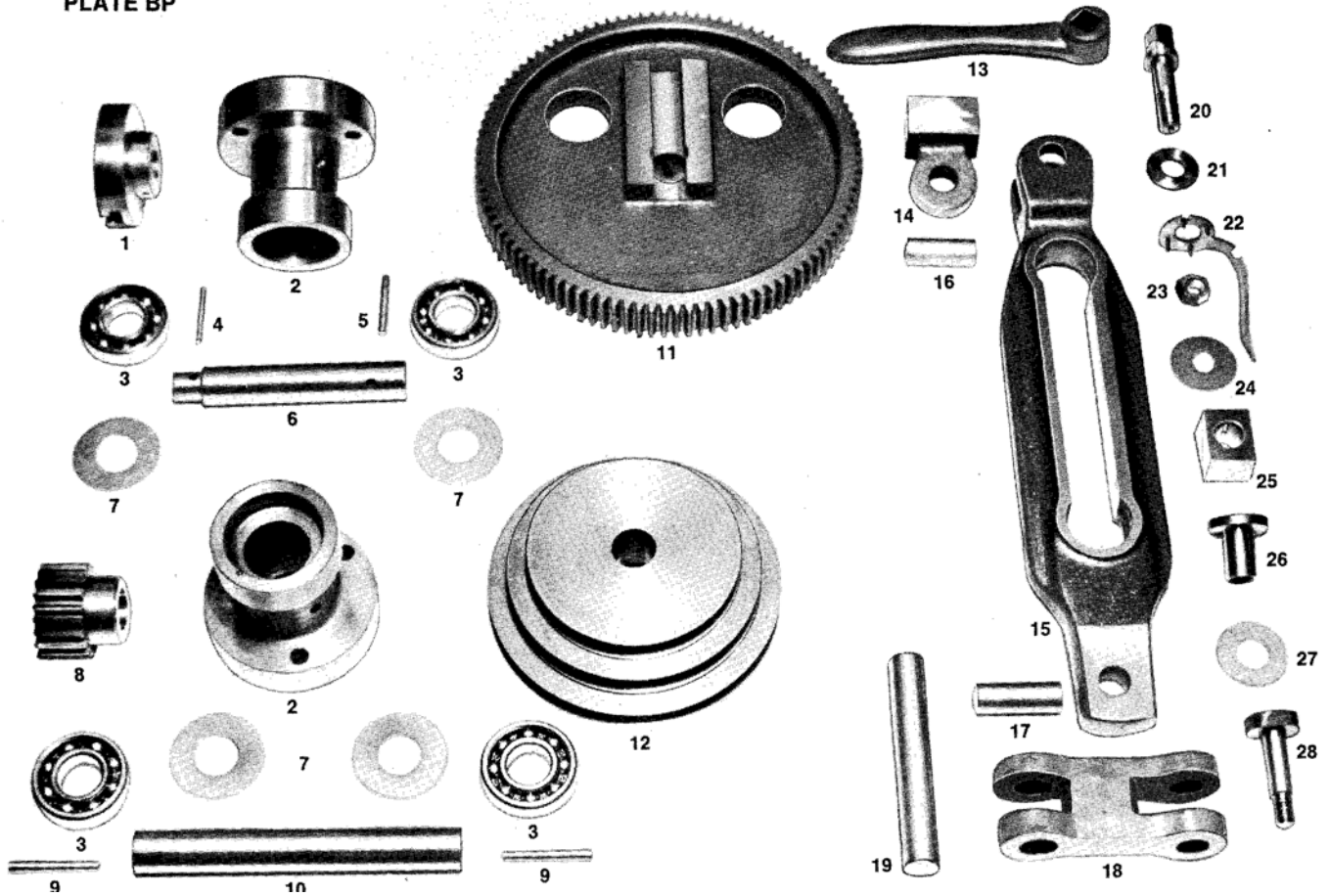

- 1 Rat. Feed Slotted Wheel
- 2 Bearing Housing
- 3 Ball Races
- 4 1 3/4 x 3/16 Pin
- 5 Taper Pin
- 6 Bull Wheel Shaft
- 7 Ball Race Washers
- 8 Pinion
- 9 Taper Pins
- 10 Pinion Shaft

- 11 Bull Wheel
- 12 Cone Pulley
- 13 Ram Locking Handle
- 14 Top Link
- 15 Rocker Arm
- 16 " " Pin
- 17 " " "
- 18 Bottom Link
- 19 Bottom Link Shaft
- 20 Ram Locking Bolt

- 21 Bevel Washer
- 22 Pointer
- 23 1/2" w Nut
- 24 1/2" Washer
- 25 Die Block
- 26 " " Bush
- 27 3/4" Washer
- 28 Die Block Bolt

## PLATE LS

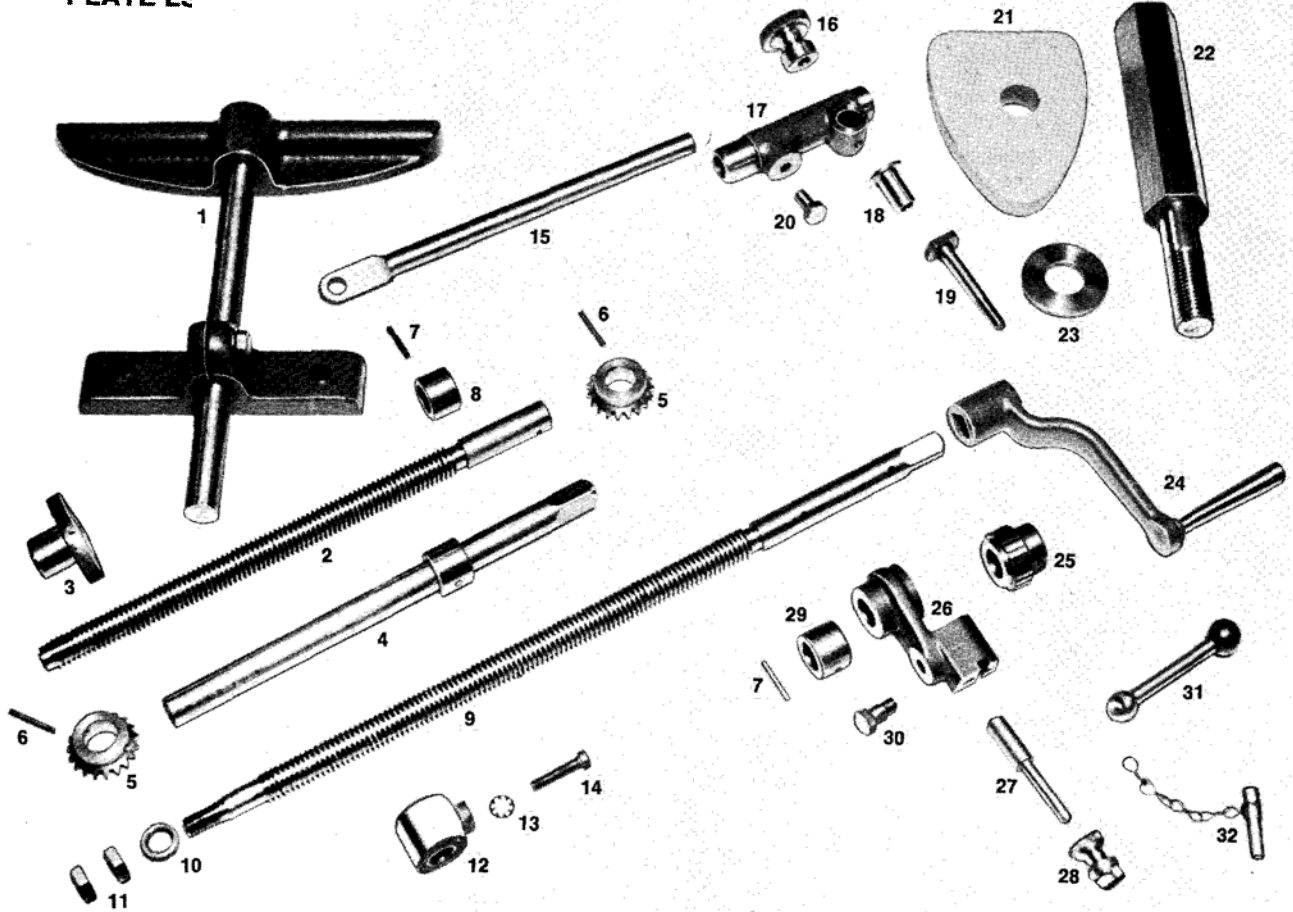

- |                       |                            |                               |
|-----------------------|----------------------------|-------------------------------|
| 1 Front Brace         | 12 Cross Lead Screw Nut    | 23 Table Bolt Washer          |
| 2 Vertical Lead Screw | 13 Washer                  | 24 Cross Feed Handle          |
| 3 " " " Nut           | 14 Screw                   | 25 Rat. Feed Gear Wheel       |
| 4 " " " Shaft         | 15 Rat. Feed Shaft         | 26 " " Bracket                |
| 5 Mitre Gears         | 16 " " Nut                 | 27 " " Pawl                   |
| 6 " " Pins            | 17 Rat. Feed Wheel Bracket | 28 " " " Knob                 |
| 7 Collar Pins         | 18 " " " " Bush            | 29 Collar                     |
| 8 Collar              | 19 " " Bolt                | 30 Stepped Bolt               |
| 9 Cross Lead Screw    | 20 Set Screw               | 31 Cross Slide Locking Handle |
| 10 Stepped Collar     | 21 Table Bolt Plate        | 32 Table Positioning Pin      |
| 11 Lock Nuts          | 22 Table Bolt              |                               |

PLATE MB

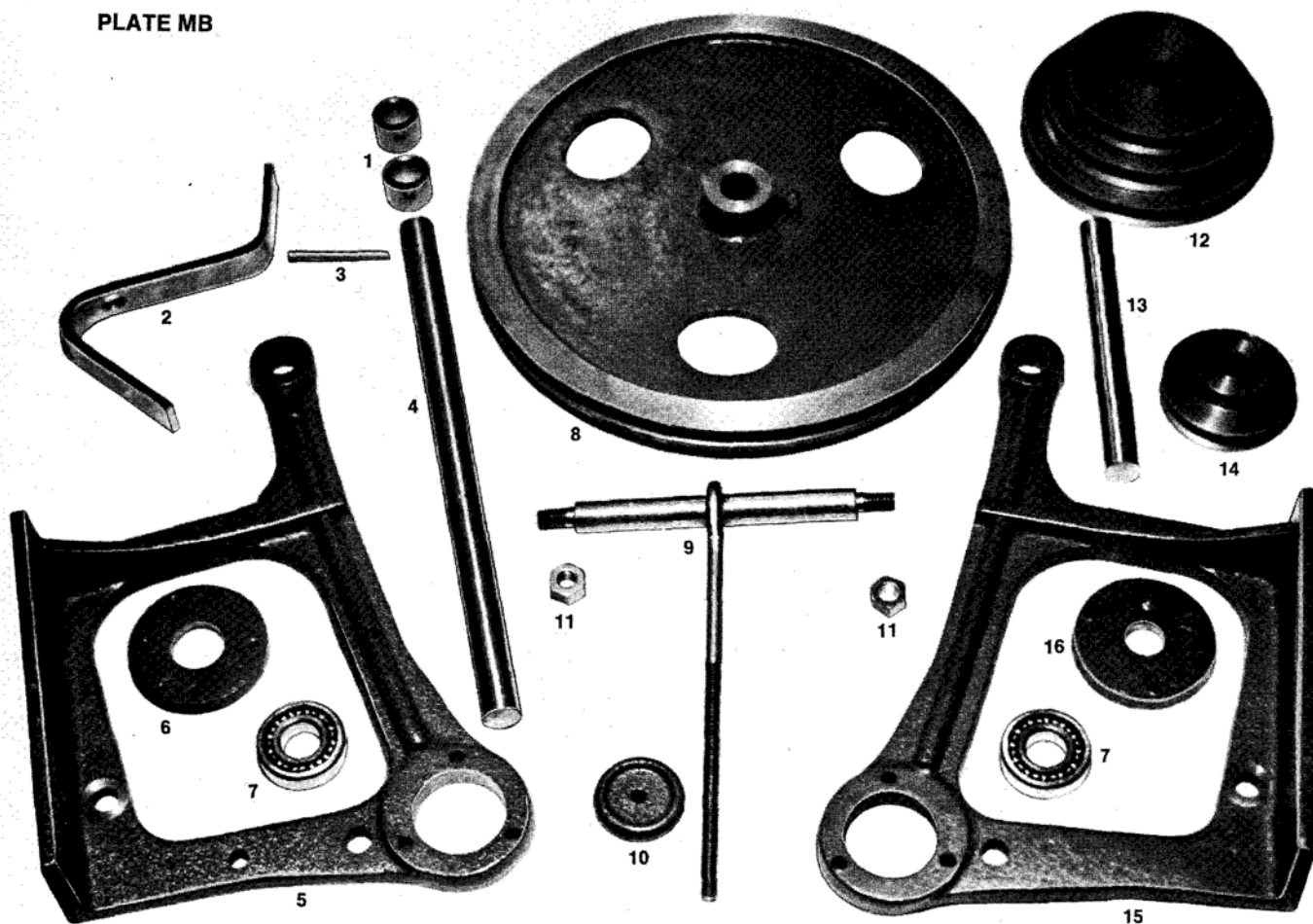

- 1 Countershaft Collars
- 2 Support Bracket
- 3 Taper Pin
- 4 Countershaft (Plain)
- 5 Motor Bracket
- 6 Ball Race Cover (2)
- 7 Ball Races
- 8 Fly Wheel (Plain)
- 9 Belt Adjusting Screw
- 10 " " Nut
- 11 ½w Nuts
- 12 Cone Pulley
- 13 Motor Bracket Shaft

- 14 " Pulley
- 15 " Bracket
- 16 Ball Race Cover (2)

PARTS NOT ILLUSTRATED

- Ram
- Ram Gib Strip
- Cross Slide
- Cross Slide Gib Strip
- Column
- Tray
- Base
- Work Table Front
- Work Table Back

- Work Table Gib Strip
- B 46 Vee Belt
- A 51 Vee Belt
- Cast Iron Main Bearings
- Doors
- Belt Guard Stud
- Table Support Pin
- Work Table Swivel Washer
- Belt Guard Brackets.
- Clutch Guards
- New Style Hinge Guards
- Old Style Hinge Guards
- Motor Pulley Guards
- Cast Iron Countershaft Bearings
- Belt Guards

PLATE CL

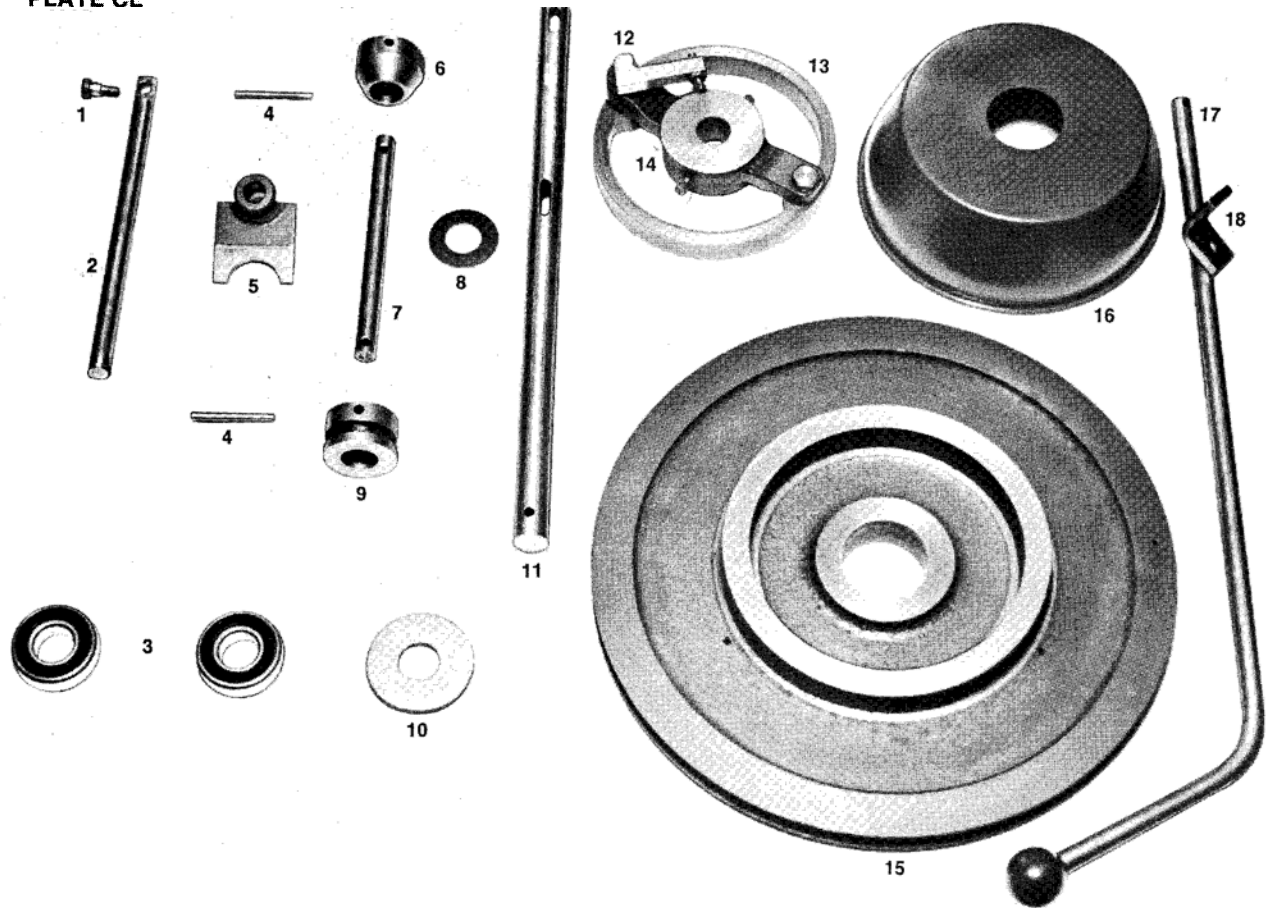

- 1 Stepped Bolt
- 2 Clutch Shaft
- 3 Ball Races
- 4 Taper Pins
- 5 Clutch Finger
- 6 " Cone

- 7 Clutch Cone Shaft
- 8 " Brake Washer
- 9 " Reel
- 10 Spacing Washer
- 11 Clutch Countershaft
- 12 " Toggle

- 13 Clutch Ring
- 14 " Bracket
- 15 " Pulley
- 16 " Cover
- 17 " Handle
- 18 " " Bracket

PLATE VP

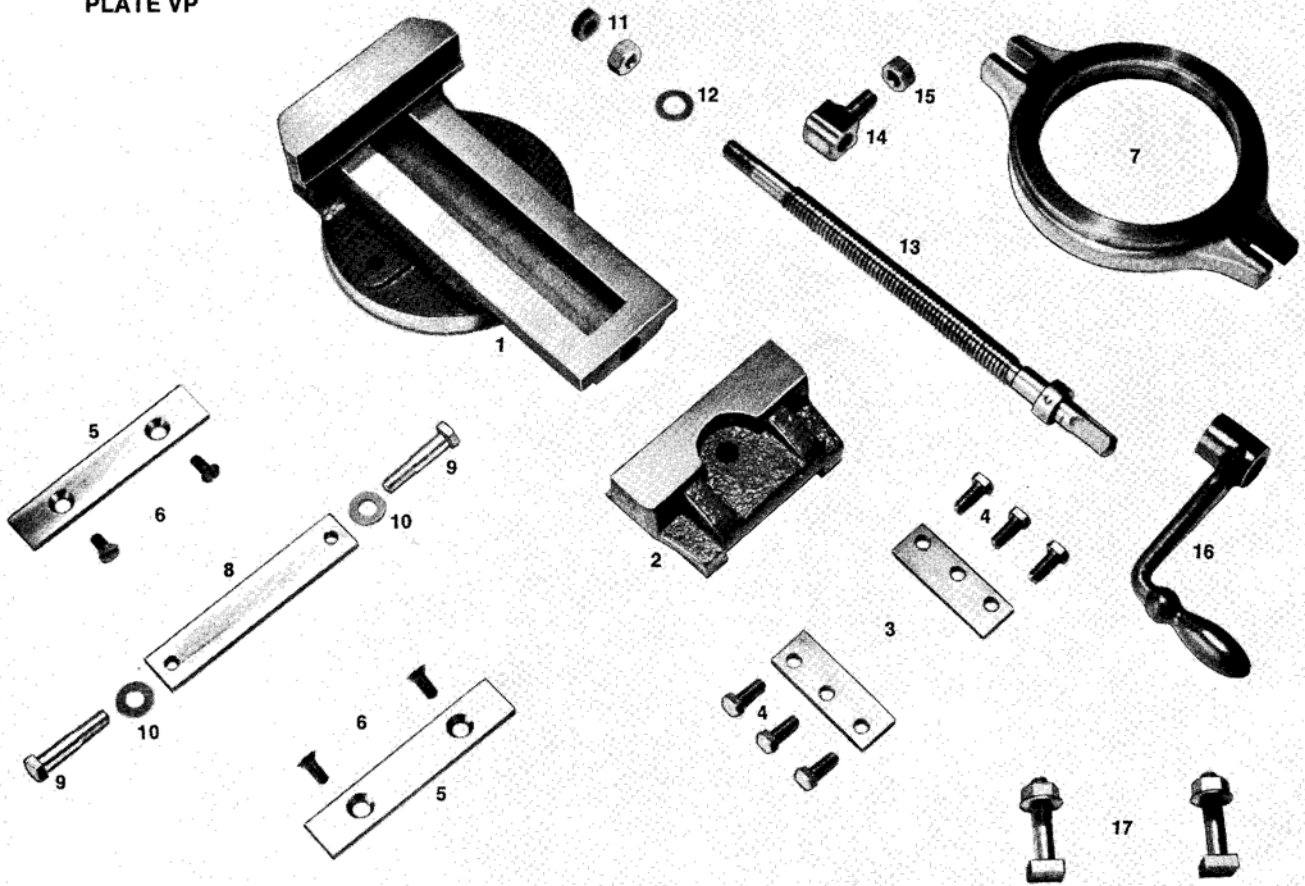

1 Vice Body

2 " Jaw

3 " " Plates

4 " " " Screws

5 " " Strip

6 " " " Screws

7 Vice Base

8 " " Plate

9 " " " Bolts

10 " " " Washers

11 1/2" w Lock Nuts

12 1/2" Washer

13 Vice Lead Screw

14 " " " Nut

15 1/2" w Nut

16 Vice Handle

17 " Bolts & Nuts

# 11" STROKE SHAPER 10 1/2" CUT

## GENERAL INFORMATION

### SPECIFICATIONS

- Stroke of Ram (Maximum) . . . 11"
- Max. length of cut . . . . . 10 1/2"
- Table movement Horizontal  
Feed (Auto.) . . . . . 11"
- Table movement Vertical . . . . . 10"
- Movement of Tool Head . . . . . 3"
- Tool Head swivels either way . . . 60°
- Size of table  
L x W x H . . . . . 10" x 7" x 8"
- Tee slots in table . . . . . 3/4"
- Angular movement of table . . . 360°
- Size of Tool Shank . . . . . 5/8" x 1"
- Ram strokes per min.,  
three . . . . . 42, 62, 88
- Motor h.p. . . . . 3/4
- Weight . . . . . 7 cwt.
- Shipping Dimensions . . . . . 40 C.F.

### STANDARD EQUIPMENT INCLUDES

5" Swivel Base Vice; 3/4 h.p. motor; 415 volt, 3 phase, 50 cycles, 51A Vee Belt; adjustable table support; B46 Vee Belt.

The Douglas 10 1/2" Shaper has been developed to meet Tool Room and Industrial demands for an economical precision-engineered and sturdily constructed machine. It has built-in accuracy and is truly versatile for rapid machining, easy setting up of work. Its high production speed, with low power consumption, make this machine an essential for work within its capacity.

### The Drive

. . . is from a 3/4 h.p. motor, through a three step pulley; vee belt drive. A clutch is optional equipment. The ram is operated by a crank and a large bull wheel; this has an adjustable connection permitting the length of stroke to be varied. Crank is so designed as to make return stroke faster than the cutting stroke. The Bull Wheel Pinion and Main Drive Shaft are mounted on Ball Bearings. All belts are fully protected to comply with safety regulations.

### The Swivelling Box Table

. . . has three T slots in the top face and two slots on one side in the vertical face with two T slots on the Front Vertical Face. The table front support is designed for use even with the table tilted, when it gives support for the full movement of the table.

### Tool Head

. . . swivels 60° either way, with a 3" effective travel and has a dial graduated in .001 division. The Tool Head is mounted to the Ram with a swivelling base, marked with a protractor scale to permit vertical or angular cuts. The Clapper Box is moveable from side to side, so that the tool will swing away from the work on the return stroke and will not mark or jam. The Clapper Box is hinged on the pin so that the tool will ride lightly over the work on the return stroke.

### Power Feed

. . . to the table transversely is variable from .005" to .03" inches per cut. A tee slotted feed wheel enables the operator to set the feed to take place on the return stroke.

### The Ram

. . . has long dove tailed bearings, providing rigid support for the cutting tools—even in the most forward position—giving maximum rigidity under the heaviest cut.